

RICHMOND BRANCH

CINCINNATI  
TO  
RICHMOND

8

5407'

7

T CORNICE Co.

NDE AIR PROD. Co.

NE MATERIALS Co.

RD Co.

INI PRESERVING

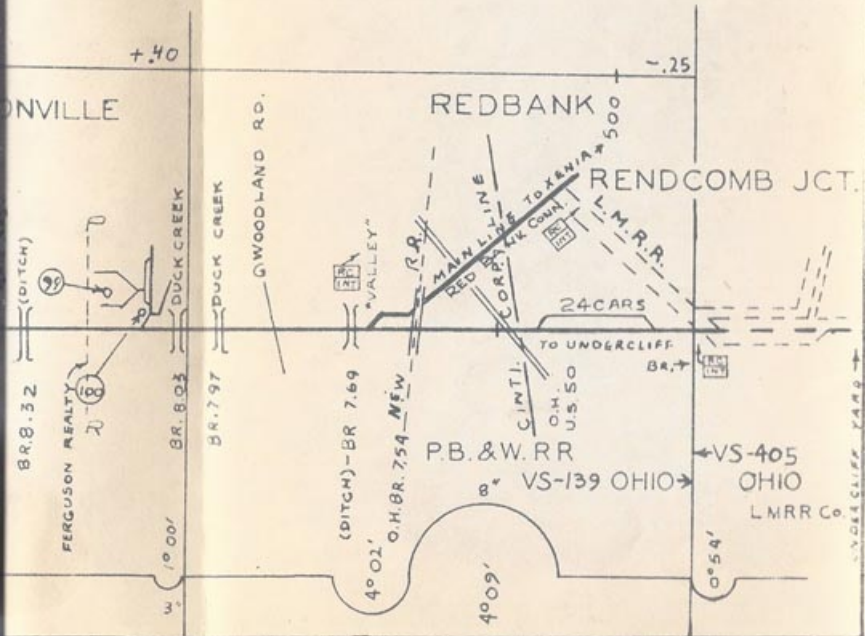

12

5265'

11

5283'

10

5412'

9

5127'

8

- 79-B HARSBAW CHEM. Co.
- 80 P.V. SHOE LUMBER Co
- 81 U.S. PLYWOOD
- 81A. GRAVRIL
- 82
- 83 PARKVIEW MARKETS INC.
- 84 VESTÉ BARTELL MECHANICAL SUPPLY
- 85 R.A. BECKER

- 86 R.A. BECKER VARNISH Co.
- 87 HILTON DAVIS Co.
- 88 KEENAN OIL
- 89 PREMIUM COAL Co.
- 90 NORWOOD HEIGHTS SUPPLY Co.
- 91 AMERICAN COMPRESSED STEEL CORP.
- 92 CINCINNATI GAS & ELECTRIC Co.

- 93 (FACTORY COLONY)
- A. CINTI. MILLING MACHINE Co.
- B. CINTI. BALL CRANK Co.
- C. ALVEY FURGUSON Co.
- D. FACTORY POWER Co.
- E. CINTI MILLING & GRINDING MACHINE Co
- 94 GEORGE R. REHM Co.
- 94-A CINTI. STEEL PROD.

- 95 WITT CORNICE Co.
- 96
- 97 LINDE AIR PROD. Co.
- 98 LINE MATERIALS Co.
- 99 FORD Co.
- 100 CINTI PRESERVING

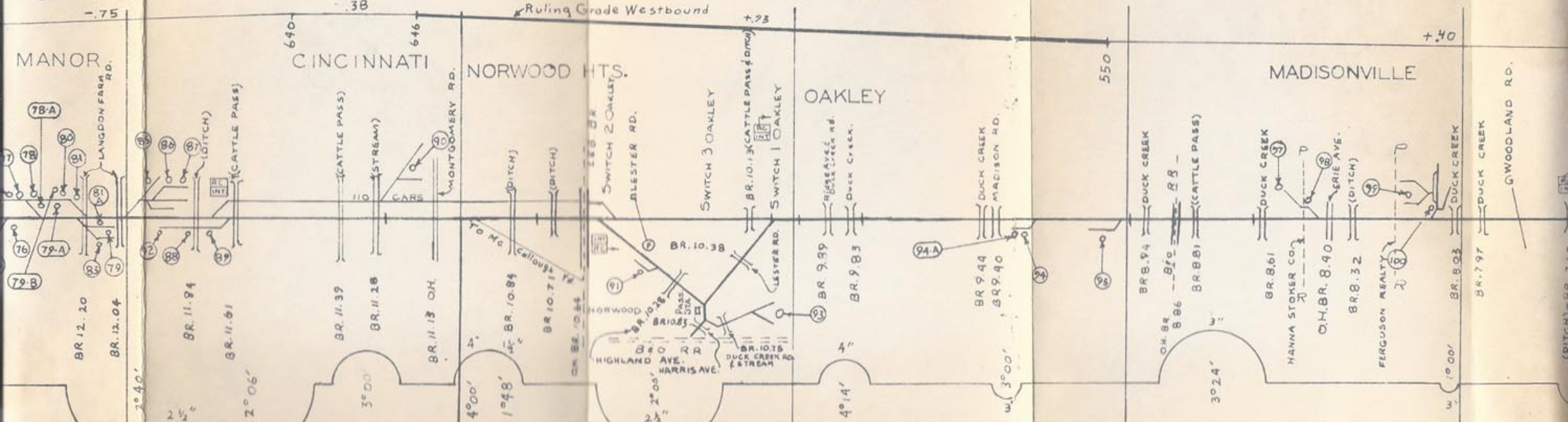

SUBDIVISION No. 10

16	5283'	15	5285'	14	5284'	13	5281'	12
ERAL ELECTRIC PERATIVE MILLS TERNATIONAL MIN. & CHEM. LISLE CHEMICAL CO. TRAL SOYA CO. ADING FEED MILL KOEHL INC. CO INDUSTRIES	62 63 NIVISON & WEISKOPF CO. 64 W. S. MERRELL CO. 65 66 PROCTOR & GAMBLE 67 NUTONE, INC. 68 OWENS ILLINOIS CO. 69 GIBSON ART CO.	70 OHIO APPLIANCE 71 F. H. LEGGETT & CO. 72 AIR REDUCTION SALES CO. 73 EMERALD LUMBER CO. 73-A CONSUMERS' MATERIALS CO. 73-B SIGNER BOTTLE SUPPLY CO. 74 CALVERT CHEMICAL 74-A VERKAMP CORP.	75 DURO BLOCK CO 76 ASHLAND OIL & REFINING CO. 77 CINTI. DOWELL & WOOD 77-A DEEKS & CO. 78 ALEX GOTTLIEB CONTAINER CO. 78-A CHEMICALS INC. 79 G. A. AVRIL LEAD 79-A IMPERIAL ADHESIVES	79-B HARSBAW CHEM 80 P. V. SHOE LUMBER 81 U.S. PLYWOOD 81A. GRAVRIL 82 83 PARKVIEW MARKET 84 VEST & BARTELL MECH 85 R. A. BECKER				

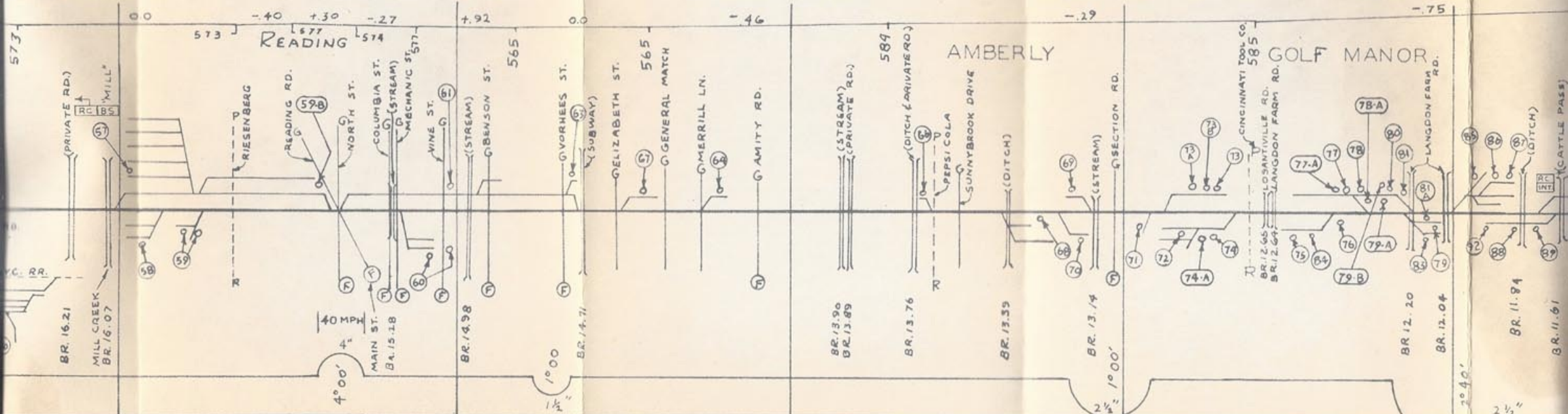

SUPERVISOR T.W. SMALLWOOD

CINCINNATI, OHIO

SUBDIV

5282'

22

5285'

21

5281'

20

5277'

19

5275'

18

5279'

17

5304'

16

- 43 CONTINENTAL MINERAL CO.
- 44 BRIGHTON CORP.
- 45 MAGNA-AMERICAN
- 46 THE MACCLEOD CO.
- 46-A GENERAL SERVICES ADM.
- 46-B CONTINENTAL CAN CO.
- 46-C VALLEY ASPHALT CO.
- 46-D OVERMYER WAREHOUSE CO.

- 47 DECOR INC.
- 47-A FORD PLANT
- 47-B SPERRY-HUTCHINSEN CO.
- 47-C RALSTON PURINA CO.
- 48 PAS, INC.
- 49 AVCO MFG. CO.
- 50 POLLAK STEEL CORP.
- 50-A FOX PAPER

- 51 WESTINGHOUSE ELEC. CORP.
- 51-A AM. CYNAMID CO.-LEDERLAB DIV.
- 52 SCOVILLE MFG. CO.
- 52-A MASONITE CORP.
- 52-B MACGREGOR BRUNSWICK
- 53 THOMAS FROZEN FOODS
- 54 RICHTER CONCRETE CORP.
- 55 FORD PARTS DEPOT.

- 56 GENERAL ELECTRIC
- 57 COOPERATIVE MILLS
- 58 INTERNATIONAL MIN. & CHEM.
- 59 CARLISLE CHEMICAL CO.
- 59-A CENTRAL SOYA CO.
- 59-B READING FEED MILL
- 60 E. G. KOEHL INC.
- 61 LOROCO INDUSTRIES

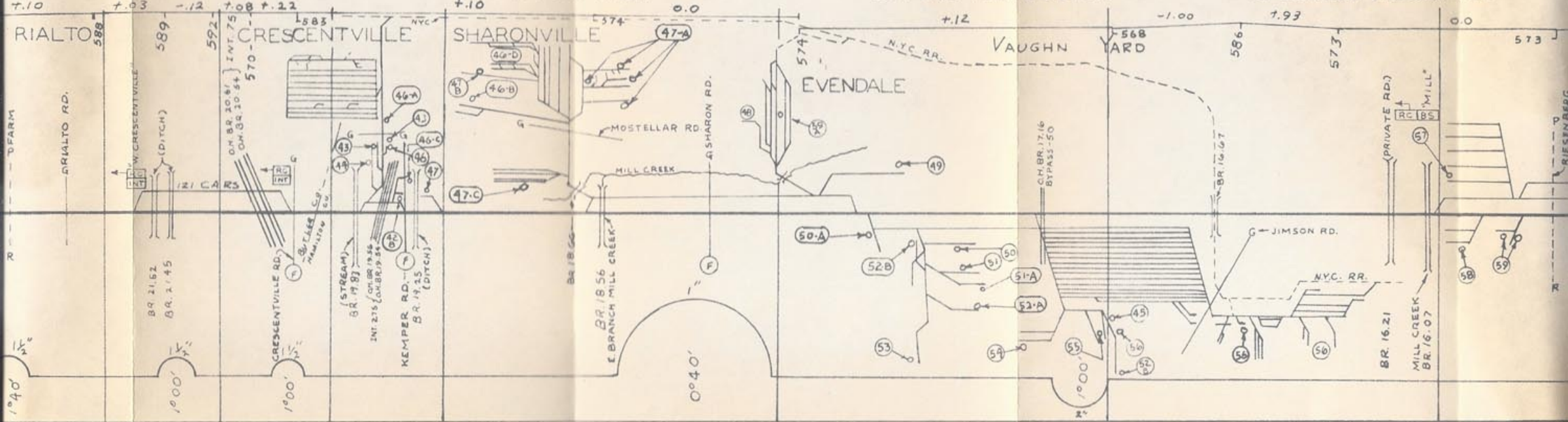

30 5213' 29 5370' 28 5193' 27 5280' 26 5282' 25 5270' 24 5363' 23 5282' 22 5285' 21

COAL & COKE Co.  
 FE & Co.  
 LLO DIST. Co.  
 HAMILTON WELDING Co.

37-C HAMILTON SKOTCH CORP.  
 37-D WRIGHT BERNETT  
 38 HERRING HALL MARVIN Co.  
 39 MOSLER SAFE Co.  
 40  
 41 HAMILTON FOUNDRY & MACHINE Co.  
 42 HAND OIL & COAL Co.  
 42A. MISSISSIPPI LIME Co (city of Hamilton)

42-B. LYNHURST WAREHOUSE CORP.  
 42-C  
 42-D  
 42-E.  
 42-F.  
 42-G.  
 42-H.  
 42-I.  
 42-J.  
 42-K.  
 42-L.  
 42-M.  
 42-N.

43 CONTINENTAL MIN  
 44 BRIGHTON CORP.  
 45 MAGNA-AMERICAN  
 46 THE MACCLEOD  
 46-A GENERAL SERVICE  
 46-B CONTINENTAL  
 46-C VALLEY ASPHALT  
 46-D OVERMYER WAREHOUSE

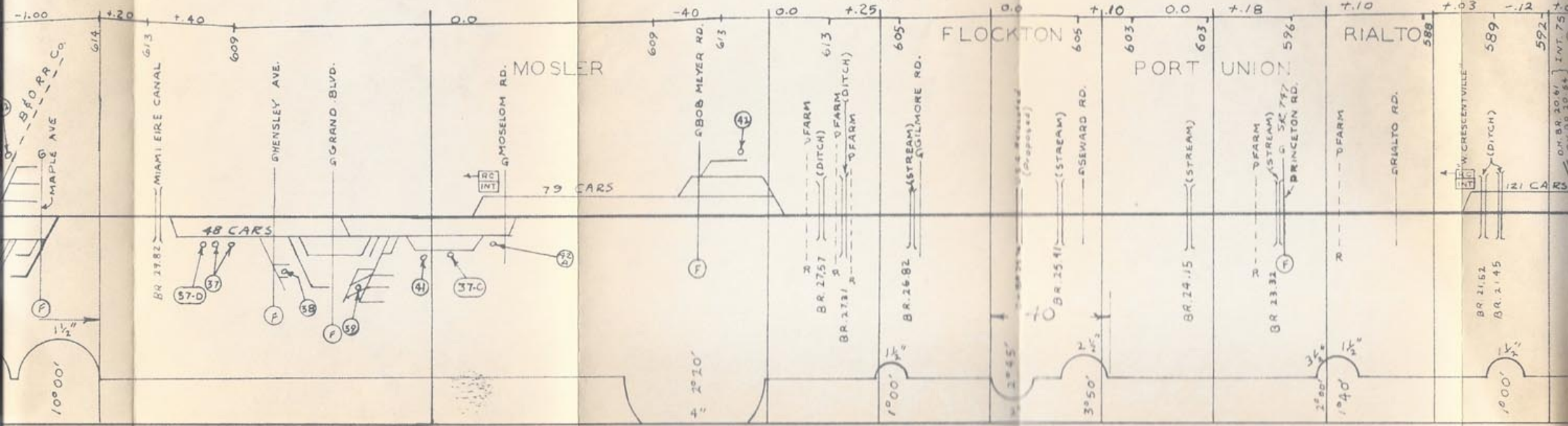

FRT.

5278' 35 5259' 34 4576' 33 4572' 32 5326' 31 5326' 30

- |                                  |                         |
|----------------------------------|-------------------------|
| 24 WARD MFG. Co.                 | 32 HAND COAL & COKE Co. |
| 25                               | 33                      |
| 26 N. RANSOHOFF INC.             | 34 WOLFE & Co.          |
| 27 BECKETT PAPER Co.             | 35 MILILLO DIST. Co.    |
| 28                               | 36                      |
| 29 VAUGHN BUILDERS, INC.         | 37 HAMILTON WELDING Co. |
| 30 HORN LUMBER Co.               | 37-A                    |
| 31 HENNEBERGER LUMBER & COAL Co. | 37-B                    |



B. & O. R.R. Co. MAX. 60 M.P.H. PASS. — 50 M.P.H. FRT.

5279' 47 5255 46 5301' 45 5282' 44 5275' 43 5269' 42 5273' 41 5278' 40 5276' 39 5283' 38 5254' 37 5288' 36 5278' 35 5259' 34

- 20-B
- 20-C CONCRETE PIPE & TILE Co.
- 21 MIAMI CEMENT PRODUCTS Co.
- 22 OPEKASIT, INC.
- 23 BUTLER FARM BUREAU CO-OP ASSN.

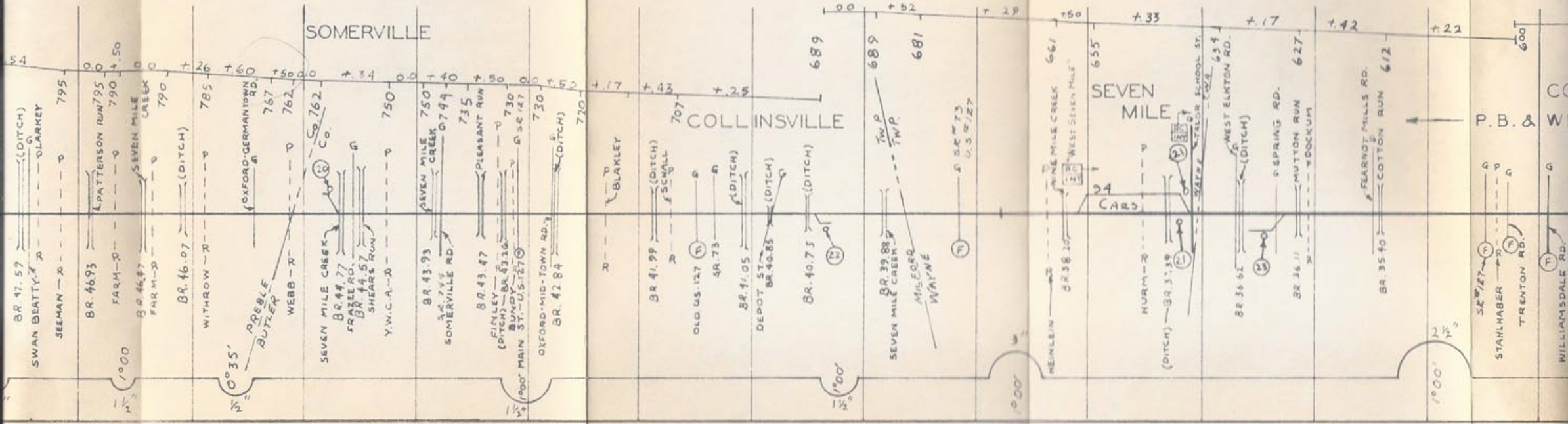



5231

57 5276' 56 5281' 55 5277' 54 5278' 53 5269' 52 5288' 51 5272' 50 5304' 49 5262' 48 5279' 47 5255' 46

15 CAMDEN STEEL CORP.  
 16 PRE-FABRICATORS DIST. CO.  
 17 WOOD BROS. COAL CO.  
 18 SOUTH SIDE LUMBER  
 19 BUELL & SONS  
 20 DUNKLEBURGER COAL CO.  
 20-A NEFF & FRY

20-B  
 20-C CONCR  
 21 MIAMI C  
 22 OPEKASIT,  
 23 BUTLER

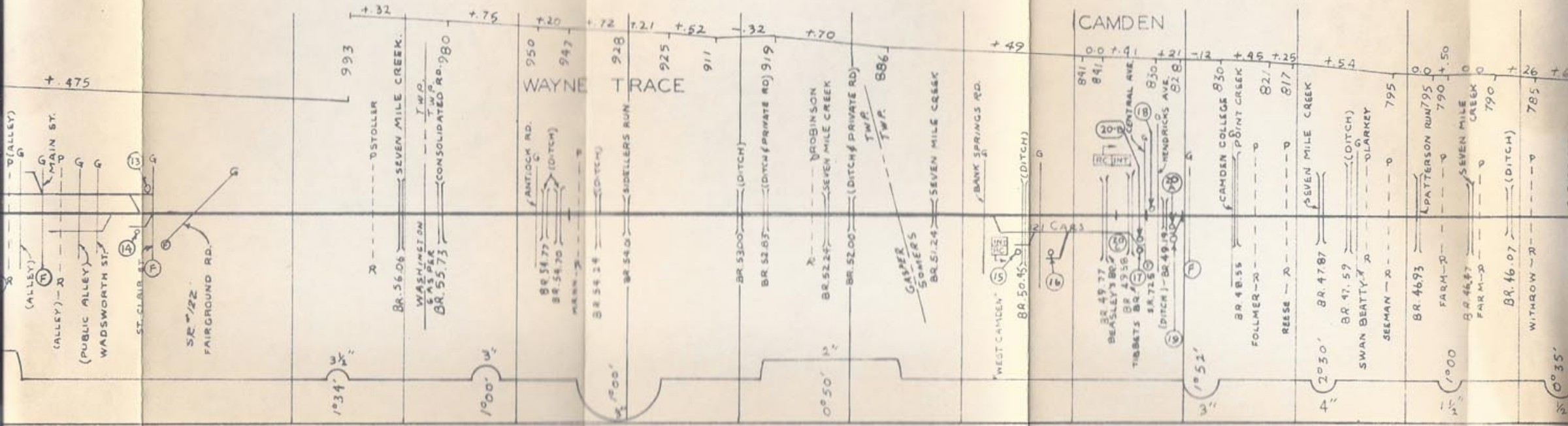

+ 475

993

+ 75

+ 20

+ 72

928

925

911

+ 52

- 32

+ 70

+ 49

CAMDEN

841

840

+ 4

+ 45

+ 25

+ 54

+ 26

1°34'

1°00'

1°00'

0°50'

1°52'

4°20'

1°00'

1°00'35"

79' 67 5268' 66 5289' 65 5283' 64 5286' 63 5280' 62 5275' 61 5285' 60 5311' 59 5277' 58 5231'

- 8 EATON MILLING Co.
- 9 J.E. PARKER & Co.
- 10 CITY COAL & SUPPLY Co.
- 11 LEATHARMAN LUMBER Co.
- 12 STATE HIGHWAY DEPT.
- 13 ERNEST NURSERY
- 14 EATON LUMBER & BUILDERS SUPPLY Co.

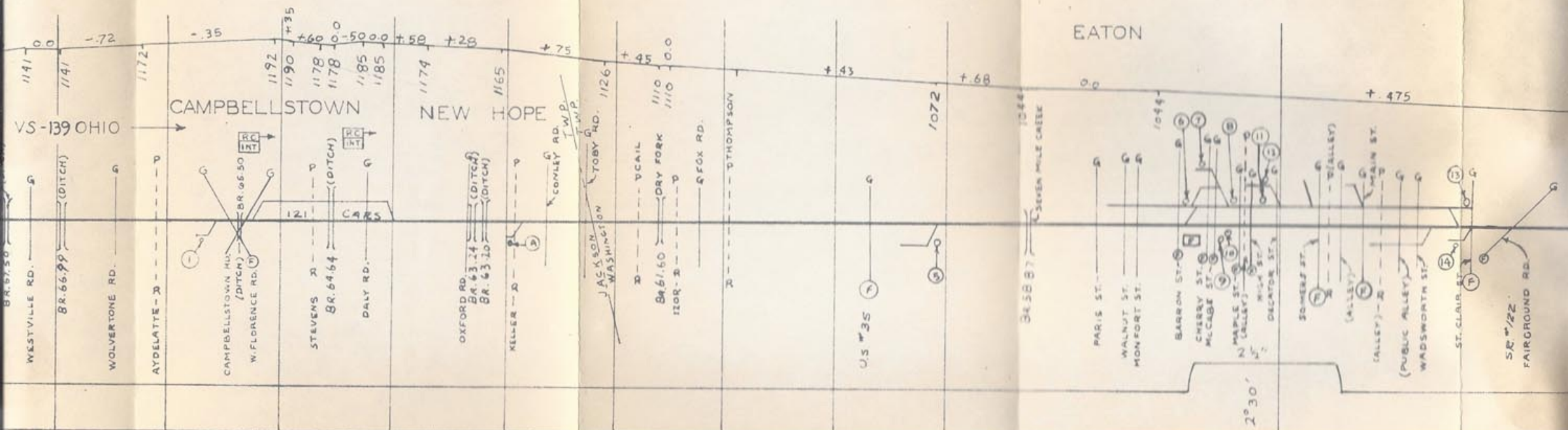

REVISOR T.W. SMALLWOOD

CINCINNATI, OHIO

SUBDIVISION No.10

72

5248'

71

5222'

70

5105'

69

5280'

68

5279'

67

5268'

66

528

1 OLIN MATHIESON CHEMICAL CORP.

2

3

4 U.M. ARMACOST ELEVATOR

5 HINDE &amp; DAUCH PAPER CO.

6 PREBLE CO. FARM BUREAU

7 THE TEXAS CO.

